

RETRACTABLE CABLE CURTAIN

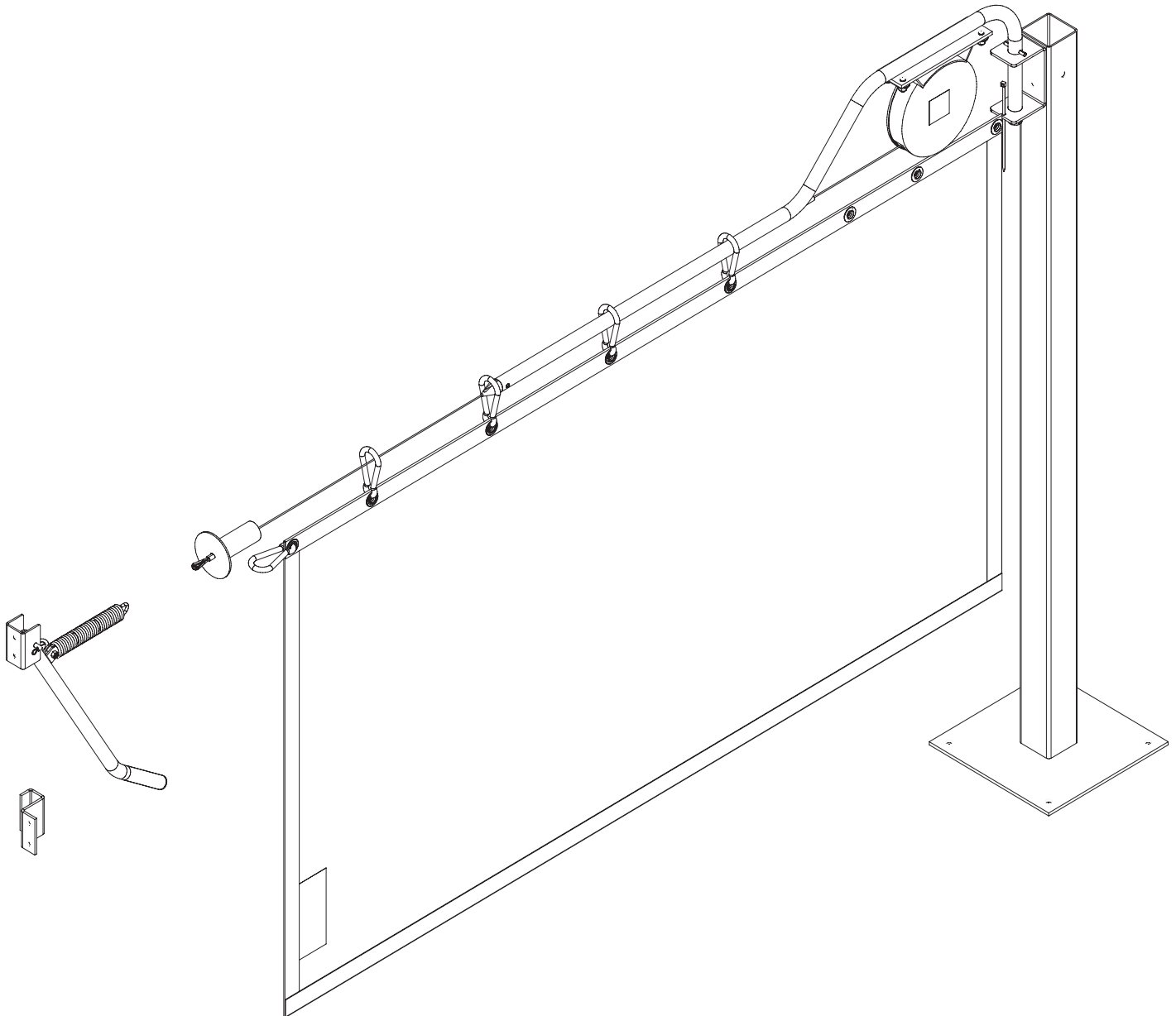

This Manual Covers All Units After 9/1/2008.

PRODUCT INTRODUCTION

TABLE OF CONTENTS

INSTALLATION INSTRUCTIONS	3
SUPPORT POST INSTALLATION	3
CURTAIN INSTALLATION	4
OPERATING INSTRUCTIONS	5
PARTS LIST	6
TROUBLESHOOTING	7
MAINTENANCE CHECKLIST	7
ARCHITECTURAL DRAWING	8

INSTALLATION TOOLS REQUIRED

- 1/2" Socket/Wrench
- 7mm Wrench
- Drill (Cordless or Electric)
- 25' Tape Measure
- 6' Carpenters Level
- 6' Step Ladder
- Hammer Drill
- 3/8" Masonry Bit

RECOMMENDED MOUNTING FASTENERS

Mounting hardware not provided.

Wall	Fastener
Wood	5/16" x 1 1/2" Lag Screw
Steel	5/16" x 1" Bolt or Self Tap/Drill Screw
Masonry	5/16" Anchor

SPECIAL FEATURES

- Heavy-Duty Industrial Materials
- Size Variations
- Fabric Choices
- Easy Operation
- Protection From Weld Flash and Debris
- Minimal Installation Time
- Easy removal for material handling equipment.

RECOMMENDED SERVICE PARTS

Clamp, Cable, 2 Bolt, 3/32 (2)	16700044
Guide, Cable, X-Ten (1)	51350075
Hook, Curtain, X-Ten (2)	52900011
Bolt, Eye, 1/4-20 x 3/4"ID x 1 3/16" OD (1)	67860123
Spring, Extension, 1 1/4"OD x 7 5/8" x .207 (1)	70700072

SUPPORT POST INSTALLATION

! DANGER !!!

When working with electrical or electronic controls, make sure that the power source has been locked out and tagged according to OSHA regulations and approved local electrical codes.

! CAUTION !!!

A floor that is not sound may cause personal injury and/or equipment damage due to failure or collapse of the X-TEN.

It is important to verify the following basic information before starting with the installation.

TO PREVENT DAMAGE TO CONTENTS, STORE DRY BETWEEN 40° AND 80° F.

NOTE: *The X-TEN can be installed either as a free standing unit or mounted to a wall.*

1. Which workstation and which side of the workstation is the unit to be located ?
2. If a base plate is not being used, how will the unit be mounted ?
3. Is anything buried in the floor where the anchors go ?
4. Does the installation allow for clearance for robotic, machining, welding or other types of operation ?

5. Does the installation meet all applicable robotic, machining, welding or other workstation safety requirements such as is contained in the following:
 - a. OSHA Instruction CPL 2-1.24 (Mechanical Power Presses)
 - b. UL Standard for Safety UL 325 (Door, Gate, Louver and Window Operators Systems)
 - c. ANSI RIA R 15.06-1999 (Industrial Robots and Robot Systems Safety Requirements)
6. Are any special work permits required?
7. Can material handling equipment (forklifts) be detoured during installation ?
8. How will the work area be barricaded ?
9. Does the customer wish to be present to observe ?
10. Check that floor is in sound condition and does not have cracks or other flaws so that the post will be plumb.
11. Plan the installation so that it will not interfere with the machining, welding or other work processes of the workstation.
12. Verify unit will fit into the location, [Figure 2](#).
13. If the measurements do not agree, STOP!

NOTE: *Prints included in the parts box supercede any prints included in this owners manual.*

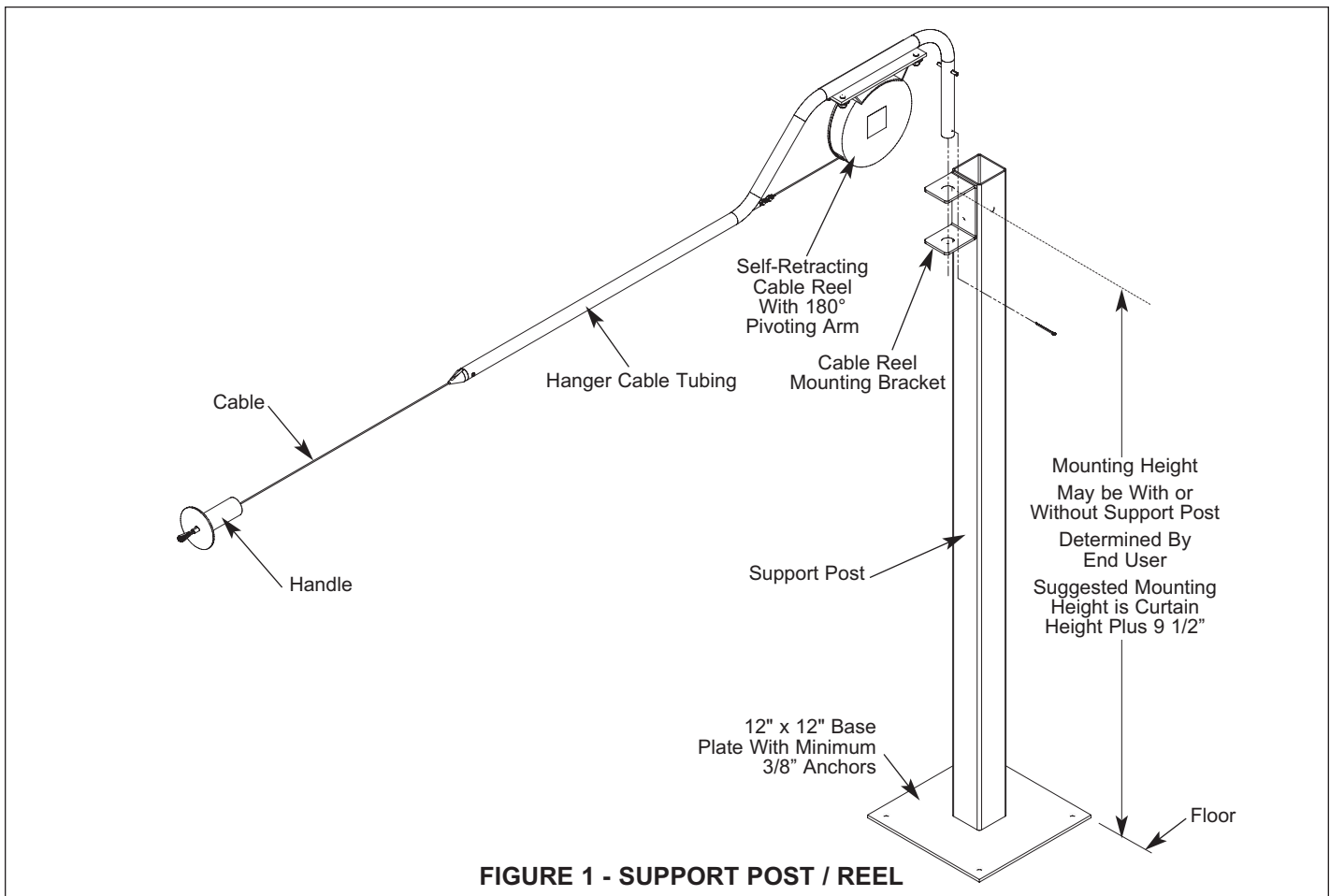

HANGER / CURTAIN INSTALLATION

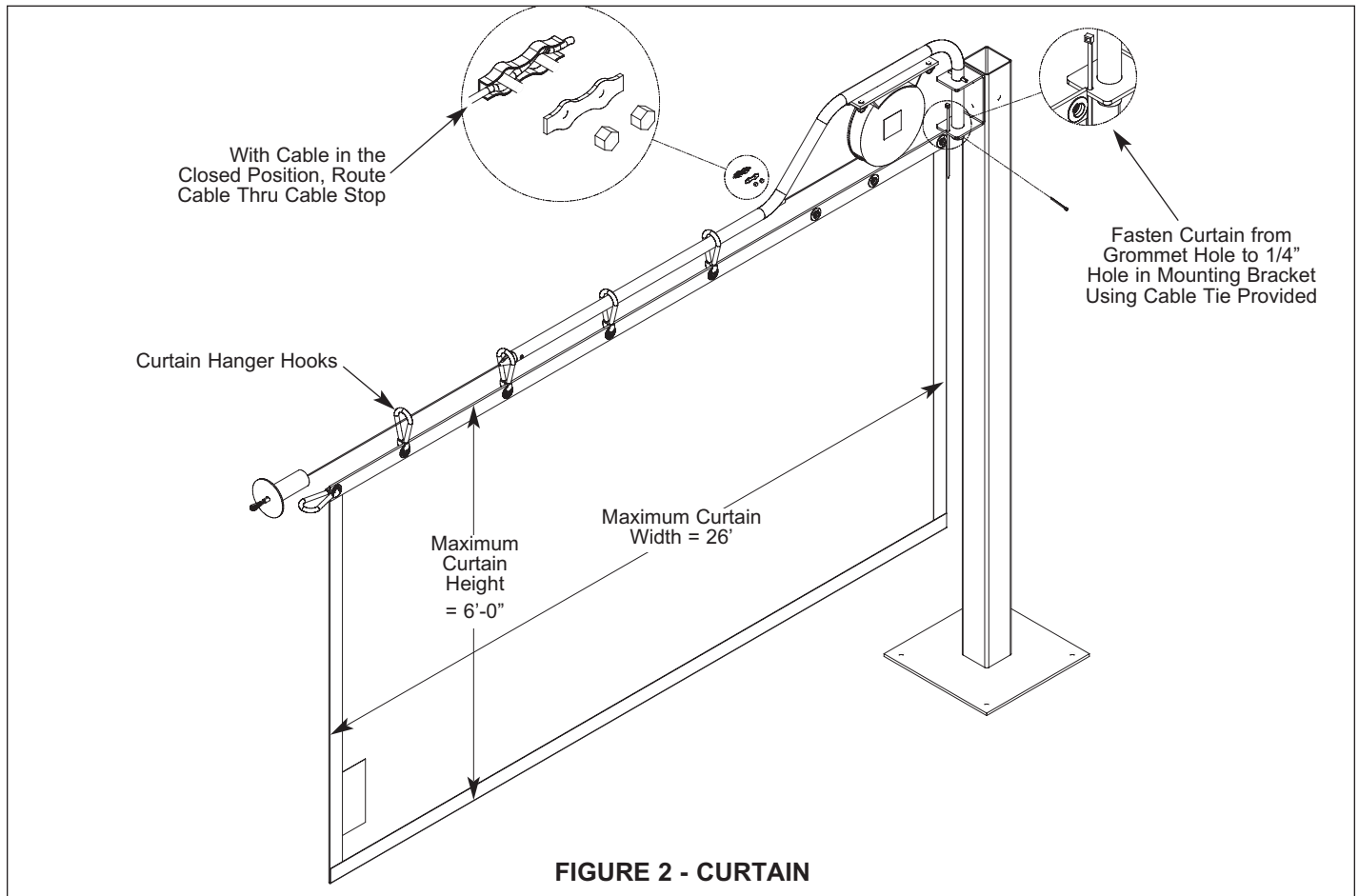

POST INSTALLATION

1. Determine proper location of post..
2. Stand post into position.
3. Verify post is square and plumb using a 6' level.
4. Mark hole location, remove post and drill holes.
5. Anchor post base plate to floor using minimum (4) 3/8" anchors, [Figure 1](#).
6. If support post is not used, proceed to HANGER INSTALLATION instructions.

Note: *The maximum installation distance is 26'-6"*, which runs from outside of hanger mounting bracket to outside of latch mounting bracket.

HANGER INSTALLATION

Note: *Curtain may sag in the middle on wider doors, make sure not to mount too close to the floor.*

1. Fasten hanger mounting bracket to the support post or wall using (2) 5/16" fasteners, [Figure 1](#).
2. Slide hanger into the mounting bracket hole and insert cotter pin, [Figure 1](#).

CURTAIN INSTALLATION

1. Fasten curtain hooks into the curtain grommet holes.

Note: *The curtain can be installed in either direction, as there is not specific front or back..*

2. Fasten hooks onto the hanger cable tubing, [Figure 2](#).

LATCH INSTALLATION

OPERATING INSTRUCTIONS

LATCH INSTALLATION

1. Locate tension mounting bracket to wall, *Figures 3 & 4*.
2. Locate latch bracket.

CABLE STOP INSTALLATION

1. With cable in the full closed position, fasten the cable stop to the taught cable with tension arm at approximately 30-45°, *Figures 2 & 4*.



WARNING!!!

DO NOT release the handle and let fly to the open position, as damage or injury may occur.

To Close:

1. Firmly grasp onto the handle and slowly walk toward the tensioner.
2. Raise and/or release the tensioner arm.
3. Attach handle to the tensioner spring.
4. Rotate tension arm and lock into the latch bracket.
5. Pull curtain to closed position and fasten lead hook to the spring eyebolt.

To Open:

1. Remove lead hook from eyebolt.
2. Slide and stack curtain/hooks onto the hanger cable tubing.
3. Release the tensioner arm.
4. Disconnect the handle from the spring.
5. Slowly walk the handle toward the hanger with cable as level as possible, as the reel automatically winds the cable until the handle reaches the cable guide. If there is a bind, pull a few inches out of the reel and try again.
6. Unit may be rotated 90° in either direction while open for storage.

Note: *If additional tensioning devices are utilized the curtain may be used in three different directions.*

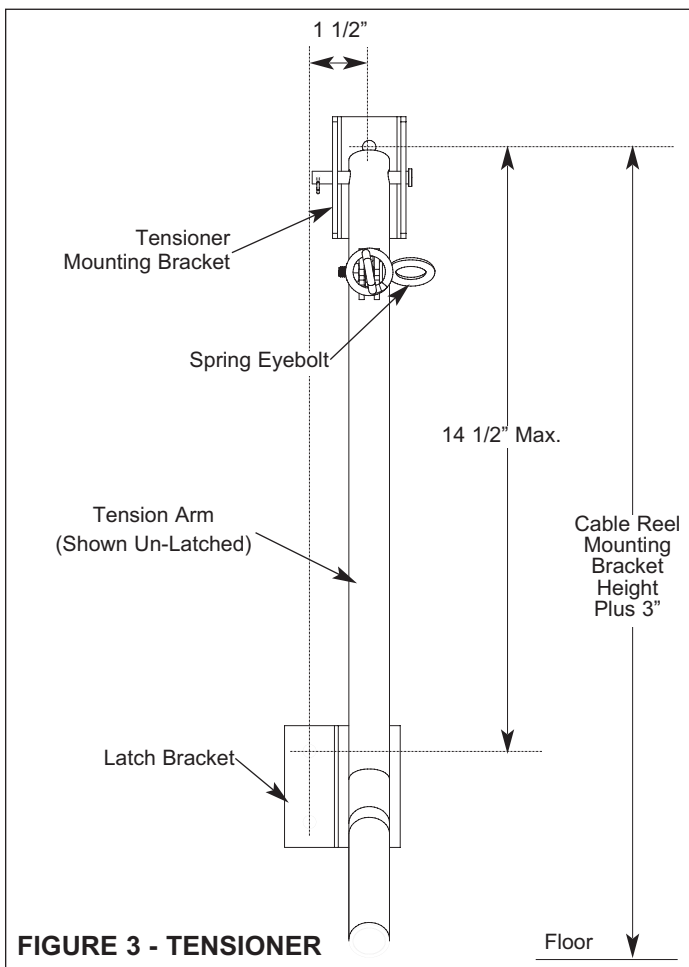

FIGURE 3 - TENSIONER

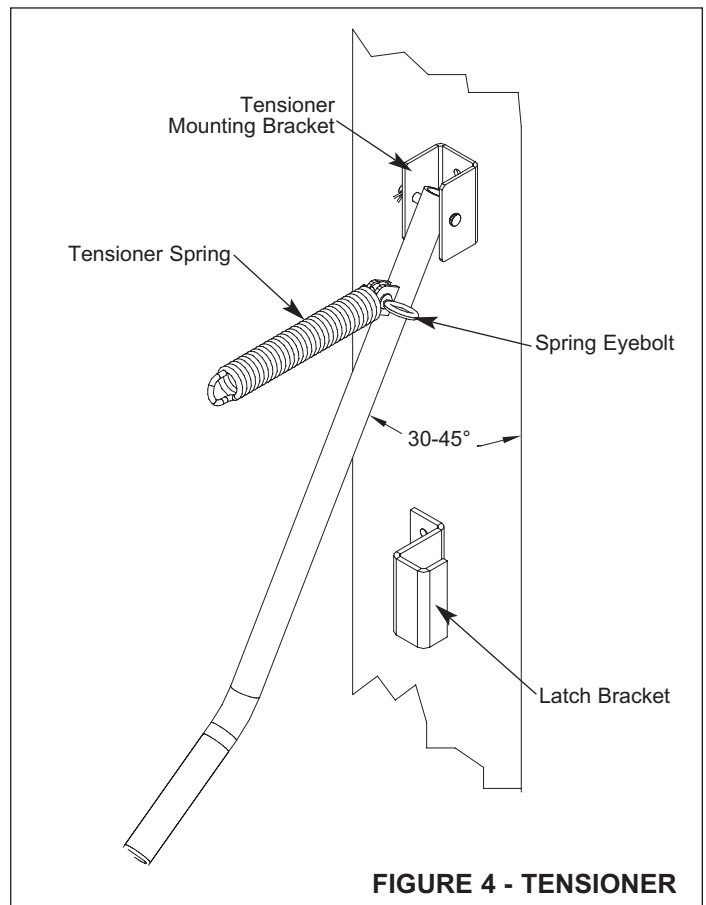
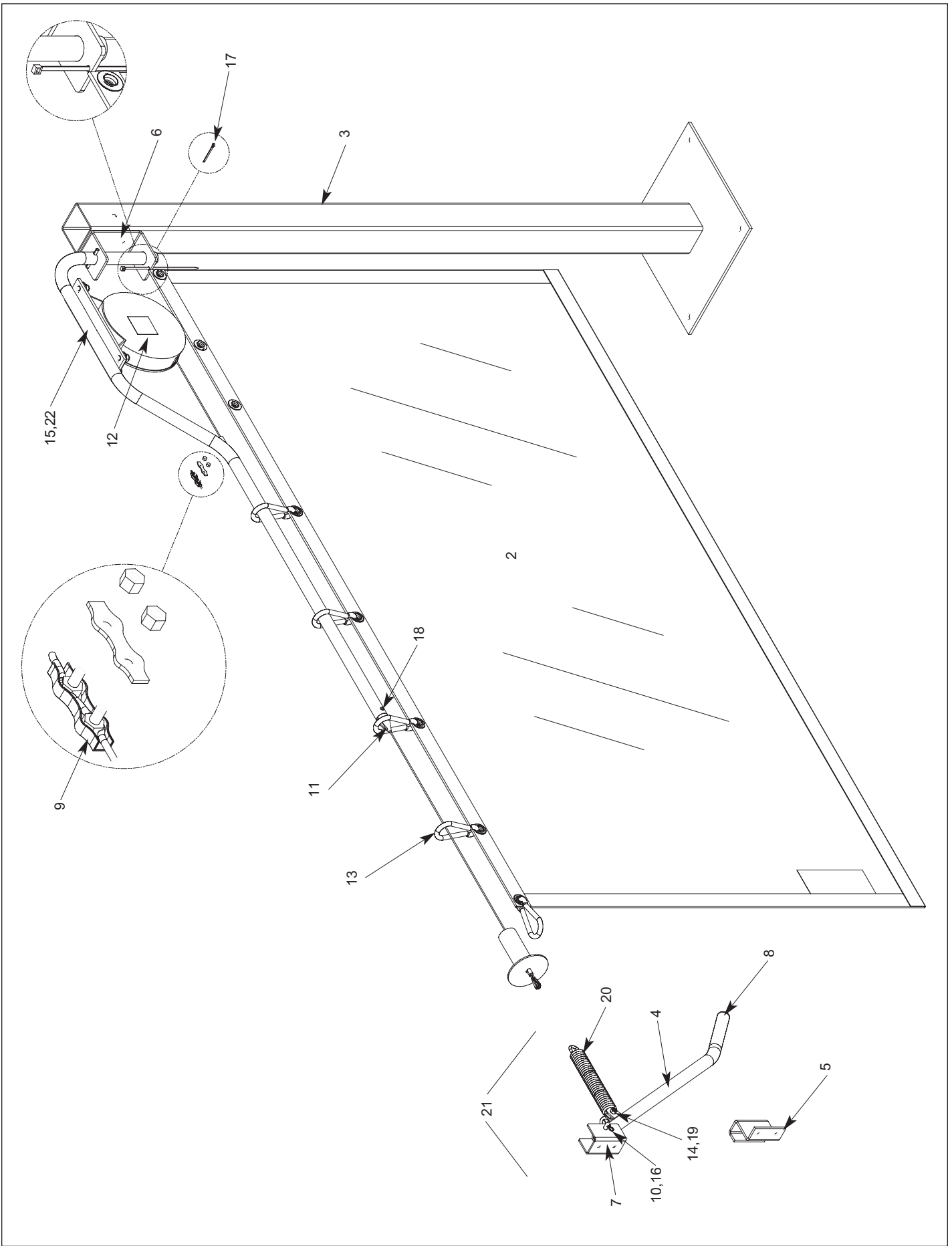

FIGURE 4 - TENSIONER

SERVICE PARTS



SERVICE PARTS LIST / MAINTENANCE / TROUBLESHOOTING

ITEM	QTY	DESCRIPTION	P/N
1	1	X-Ten Unit	601....
2	1	Curtain	601....
3	1	Support, Post	7251....
4	1	Arm, Tensioner, X-Ten	11500036
5	1	Bracket, Latch, Tensioner, X-Ten	14501120
6	1	Bracket, Mount, Hanger, X-Ten,	14501122
7	1	Bracket, Mount, Tensioner, X-Ten	14501124
8	1	Cap, Vinyl, 1"Ø x 4 1/2", BLK	16200011
9	1	Clamp, Cable, 2 Bolt, 3/32	16700044
10	1	Clip, Bridgepin, 1/4-5/16" x .058, znc	16800002
11	1	Guide, Cable, X-Ten	51350075
12	1	Hanger, Reel, Assembly, X-Ten	51900070
13	a/r	Hook, Curtain, X-Ten	52900011
14	1	Nut, Hex, Nylon, Lock, 1/4-20, znc	55610001
15	4	Nut, Hex, Nylon, Lock, 3/8-16, znc	55630005
16	1	Pin, Clevis, 5/16 x 2 3/8", znc	64020053
17	1	Pin, Cotter, 1/8 x 1 3/4", znc	64030006
18	1	Screw, RHMS, PHLF, #8-32 x 3/8, znc	67850028
19	1	Bolt, Eye, 1/4-20 x 3/4"ID x 1 3/16" OD	67860123
20	1	Spring, Extension, 1 1/4"OD x 7 5/8" x .207	70700072
21	1	Tensioner, Assembly, w/Latch, X-Ten	73000031
22	4	Washer, Flat, 3/8 x 1 x .063, znc	74130001

PLANNED MAINTENANCE

CUSTOMER:		JOB#		DATE:				
Planned Maintenance Task	Recommended P.M. Intervals (Time Shown In Months)							Inspect and Perform the Following
	1	6	12	18	24	30	36	
Cable		x	x		x		x	Inspect for fraying or wear.
Coil	x	x	x		x			Check for proper recoil.
Curtain			x		x		x	Clean with warm non abrasive soapy water.
Mounting Hardware		x		x		x		Tighten all hardware.
Overall Unit	x		x		x			Operate unit and make sure all operations are functioning properly. Perform visual inspection for damage. Use air hose to remove dust and debris. Replace any worn labels.
Spring	x		x		x			Verify spring holds unit in the closed position.

PROBLEM	REMEDY
Curtain	The curtain provides a safety barrier against sparks, harmful light emissions and physical contact with the machine by the operator. Hooks are fastened to the curtain grommets to hang the curtain from a guide cable.
Curtain or tension arm will not fully close	Make sure curtain stop is properly set.
Curtain does not open automatically.	Curtain MUST be manually stacked onto the hanger to remove weight from the cable prior to releasing cable.

